

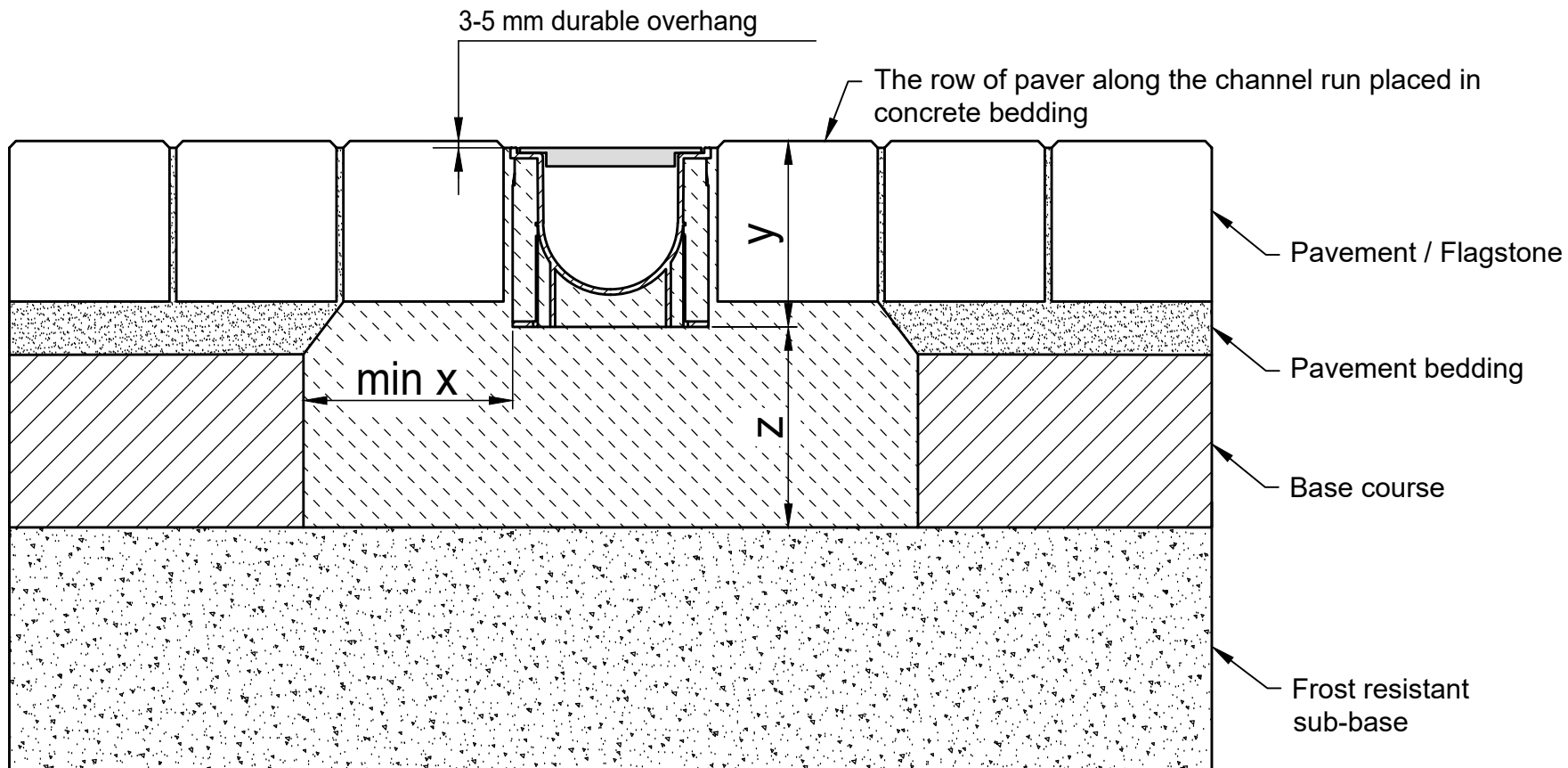

Installation example Pavement class C 250



* y = Channel height plus camber

Category according to EN 1433 / DIN 19580		A 15	B 125	C 250	D 400**	E 600	F 900	Applying to following systems: RECYFIX STANDARD 100, 150, 200, 300 RECYFIX PLUS 100, 150, 200, 300
Foundation: width x / height y / thickness z (in cm)				10 / * / 15				
The named concrete quality is a minimum quality								
EN 206-1 / DIN 1045-2	without danger of frost on the lateral support			C25/30 XF1				
	with danger of frost on the lateral support			C25/30 XF3				
The installation examples / advise constantly are adapted to the technical conditions. With new editions older expenditures lose their validity. Before planning or installation please verify the current version at www.hauraton.com In building construction is a sealing layer below the channels necessary.		Date: 02.12.2019			Our general installation instructions apply.			Format DIN A4
		0000023610.dwg EBBw						scale 1:5
		RF-StaN-100 Typ 01 Rinnenunterteil Einbaubeispiel Klasse C 250 in Pflaster						
** Not for use in continuously frequented areas of carriageways or motorways								 Unit 4, Frenchs Avenue LU6 1BH Dunstable / Bedfordshire Tel. +44 1582 50 1380 technical@hauraton.co.uk